



Toki

All creations by Lineasette are a result of constant research and of a unique and captivating design. Our goal is to convey emotions through objects capable of preserving their own harmony and handcrafted value.

When Lineasette was established as a research and testing ceramic workshop, we aimed at discovering new stylistic forms and production techniques to enrich and to blend with the local pottery handicraft tradition typical of the area around Nove, Veneto, Italy. Forms and techniques, which could and have now become the distinctive element of our artistic identity.



Emotion, Craftmanship, Harmony

Toki

Cubist Geometries

Solid and hollow geometries. The idea stems from light and shade, two opposites supporting and complementing each other.

What fuels our efforts is the desire to make pottery, fashioned in new and contemporary shapes, the star of interior design.

What we see is an artistic form to embellish and enhance the domestic environment of modern houses, where everything is minimalist and essential.

We have created a dynamic form, which goes beyond geometry and bursts into space through mutating shapes.

The name Toki represents our new design's Venetian origins, as in the local dialect the word means "combination of pieces".

Toki is entirely designed and produced in Italy.

It was first created to become a partition wall inside the house or a sunshade out in the garden.



Toki

Toki can be used to elegantly divide two rooms such as the kitchen and the living room in a private house, or as a stylish partition wall between the hall and other rooms in luxury hotels and restaurants. Toki gives a sense of direction and order to the environment it inhabits, thus making it more accessible and graceful. Toki meets both its aesthetic and functional requirements, as its dynamic composition becomes a focal point in the room.

The material employed to create Toki is porcelain stoneware, a type of ceramic with extraordinary physical qualities of hardness and impermeability, rendered completely waterproof by its high-temperature firing process (1200° C). Porcelain stoneware is easy to preserve as it is perfectly washable with water and with any type of detergent.

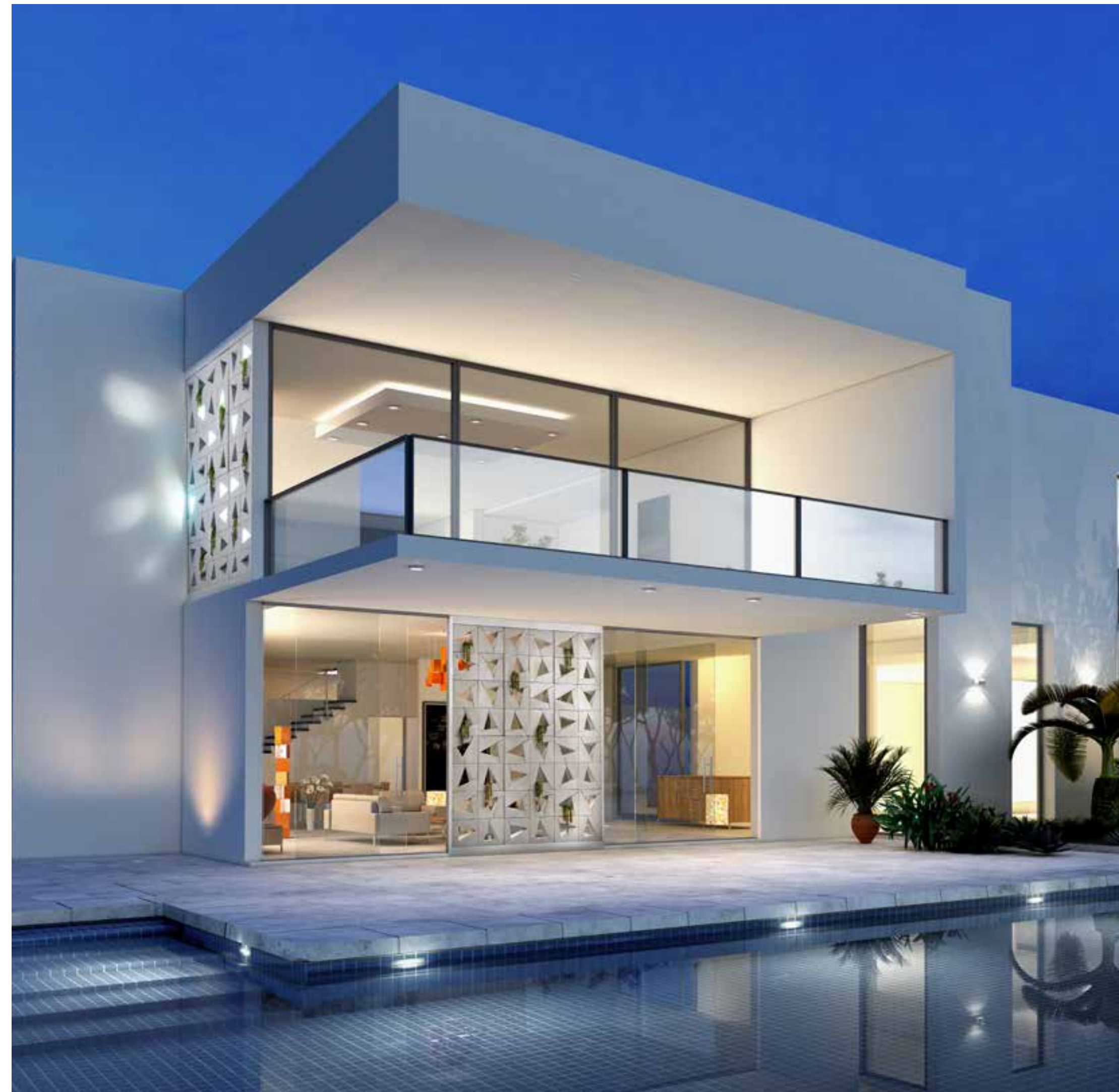

Toki



To create Toki's three pieces module, you can choose among some special elements with a built-in light source or a vase. One of the pieces can be made luminous by inserting a LED bar into a groove. The cables come out sideways and are hidden in a side track, as shown in the drawing.

Our Toki partition wall with the addition of artificial LED light makes a significant impact on the room's atmosphere, enjoyable at all hours.

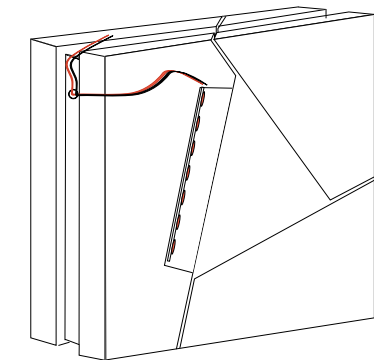



Toki

Toki can also accommodate plants. One of the three modular pieces can, in fact, be hollow and become a vase. With vegetation, the module composition is even more pleasant. Perfect to be placed in entrance halls in restaurants, villas and luxury hotels, Toki infuses personality and elegance to any environment. It can be also placed outside, as it is resistant to all climatic conditions.

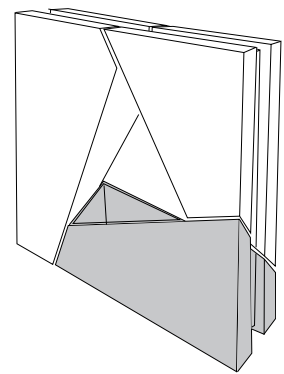

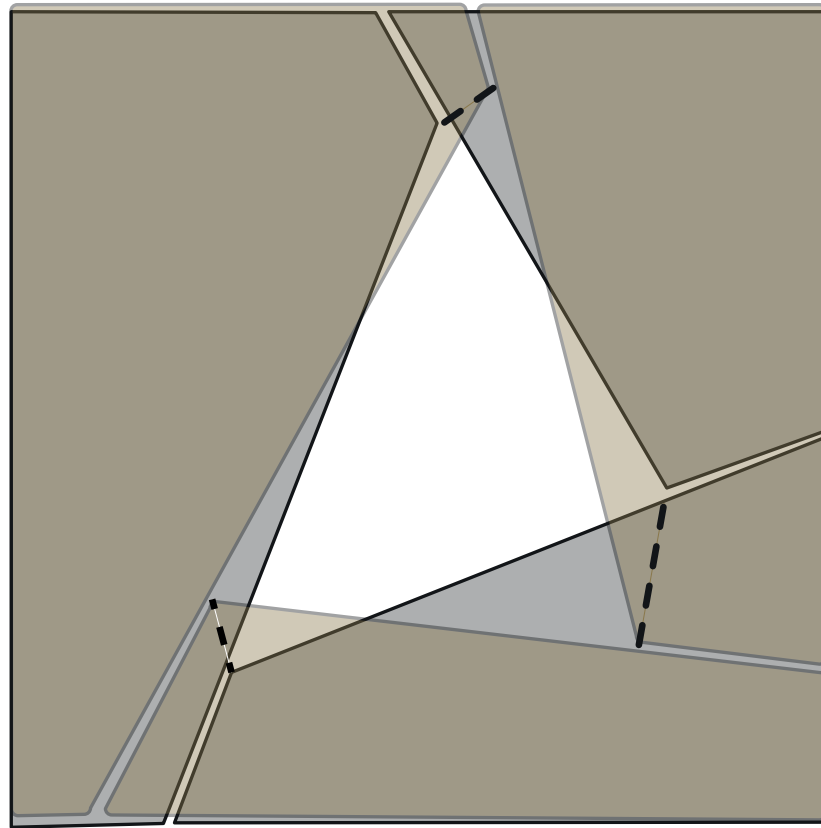

The peculiarity of this module is that its front and its back are different and it allows you to obtain an ever changing and dynamic final design. The partition wall is made of square sectional modules with different back and front patterns, allowing you to choose different combinations for the composition of your wall. Each module can rotate 90, 180 or 270 degrees, it can be turned upside-down and it can further revolve. You can go for more geometric regular patterns to obtain a neat and orderly wall, or for more dynamic combinations by assembling different modules randomly. This allows architects and interior designers to create varied compositions, playing with rotation, reflections and colors.

first example of rotation

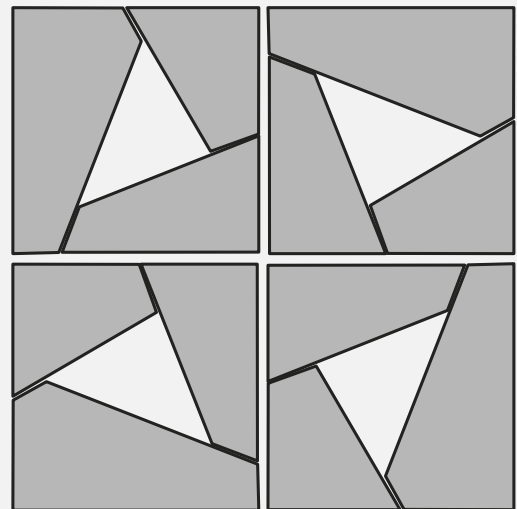

second example of rotation

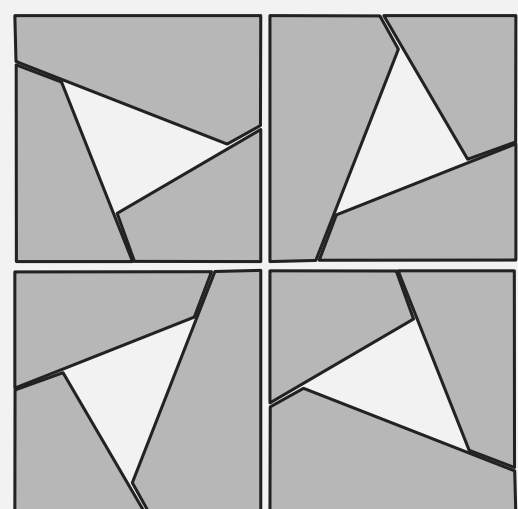

third example of rotation

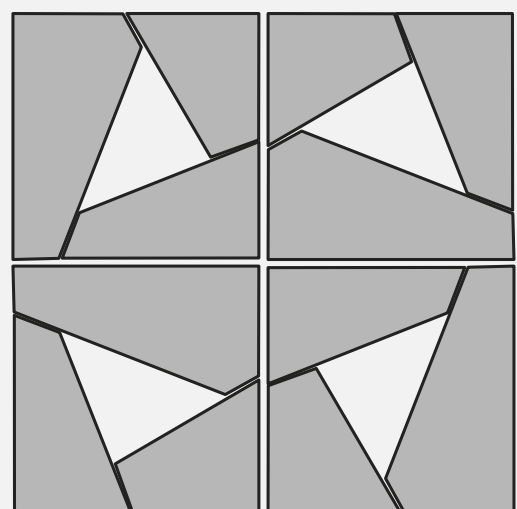

Toki

composition with first rotation



Toki

rotation + reflection fourth example of composition

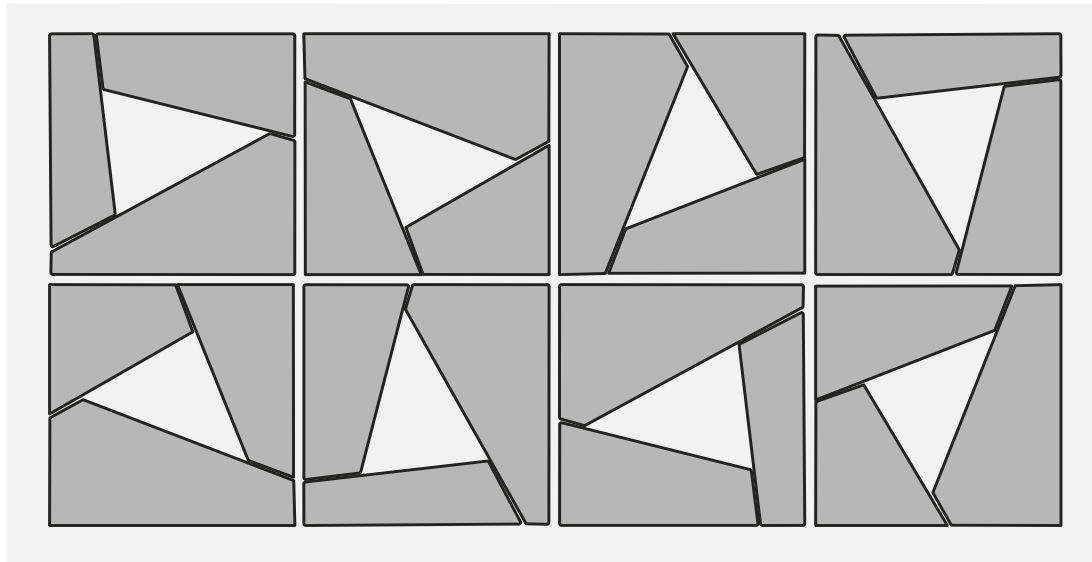

rotation + reflection fifth example of composition

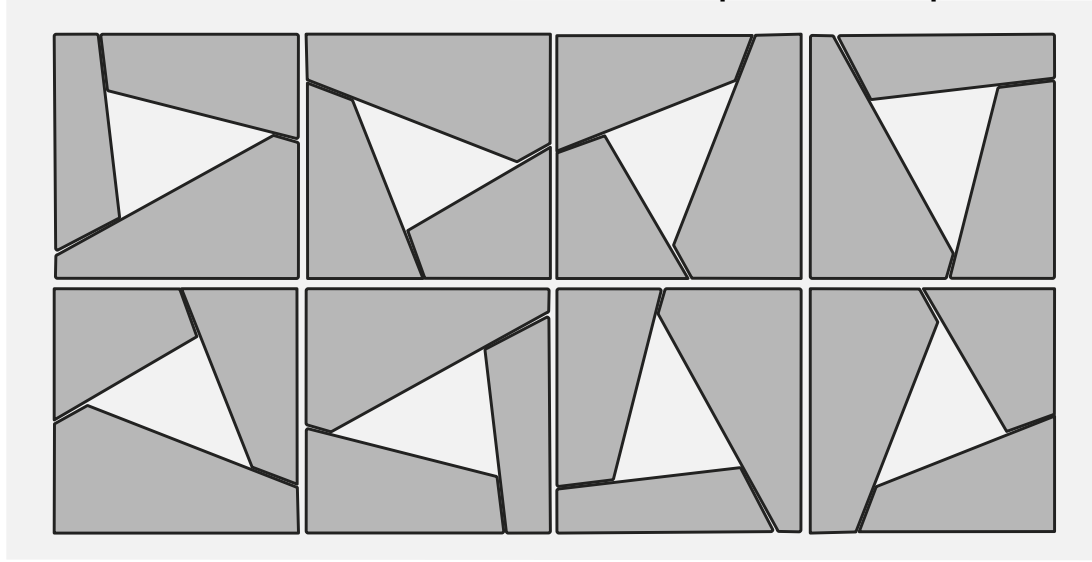

rotation + reflection sixth example of composition

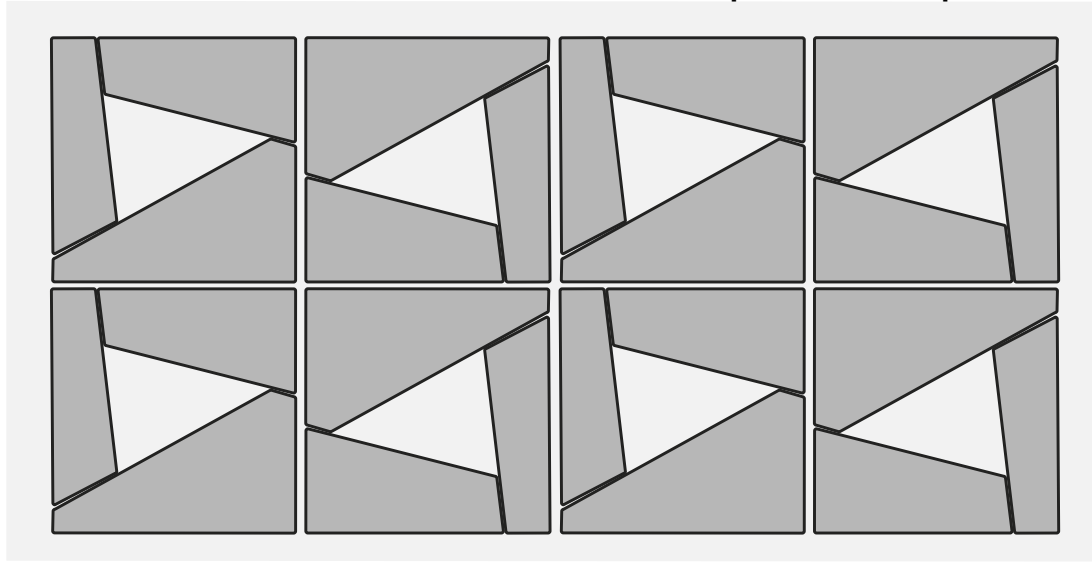

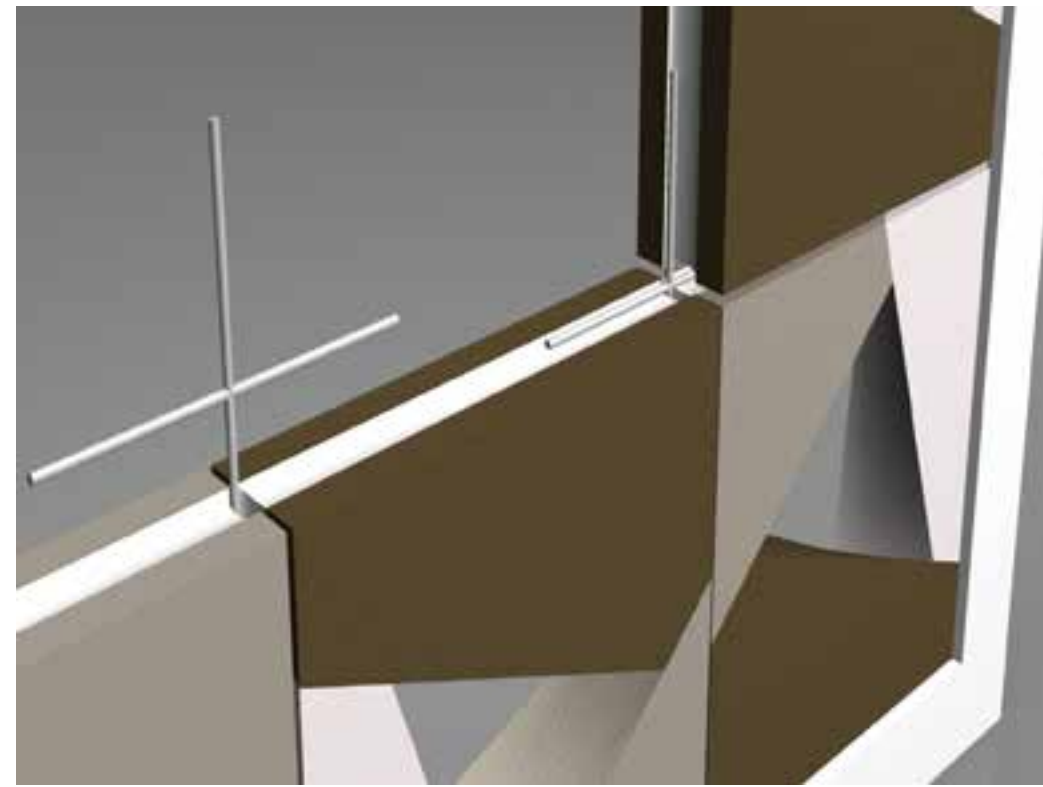
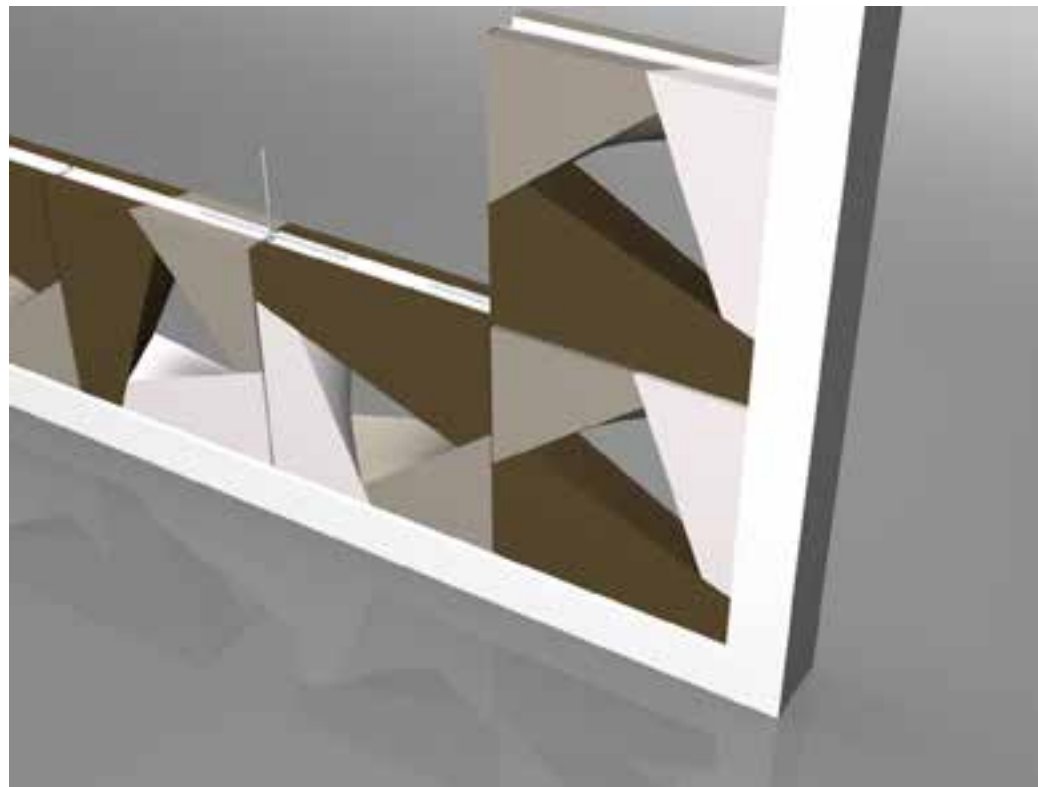
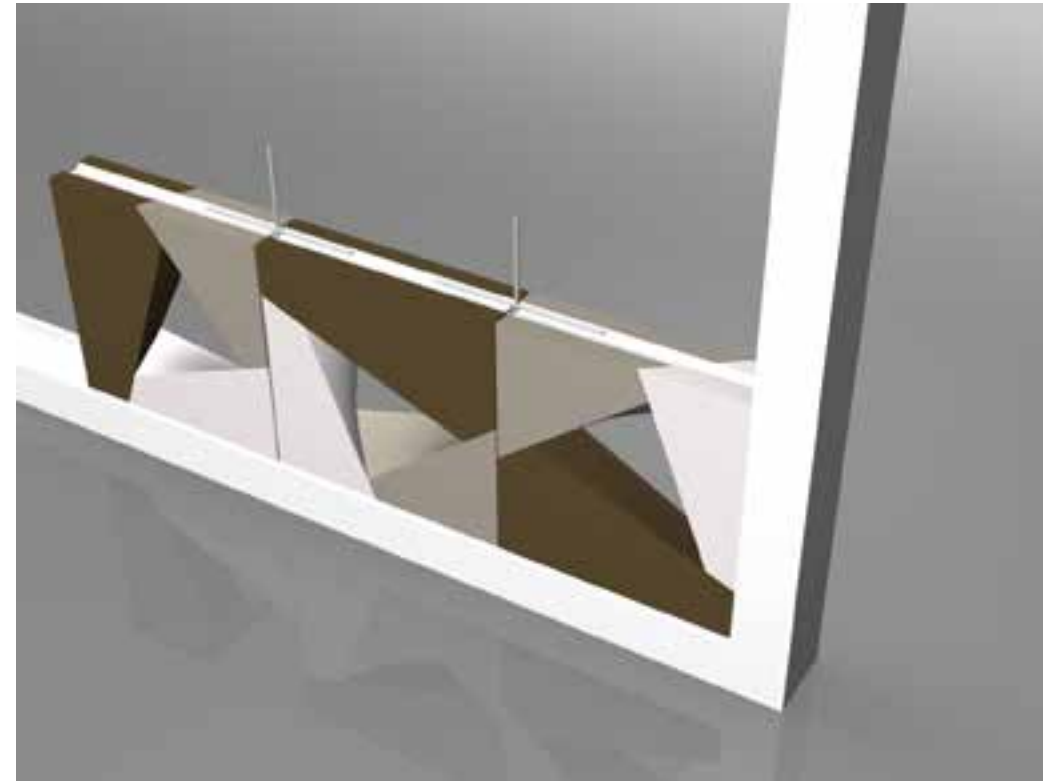
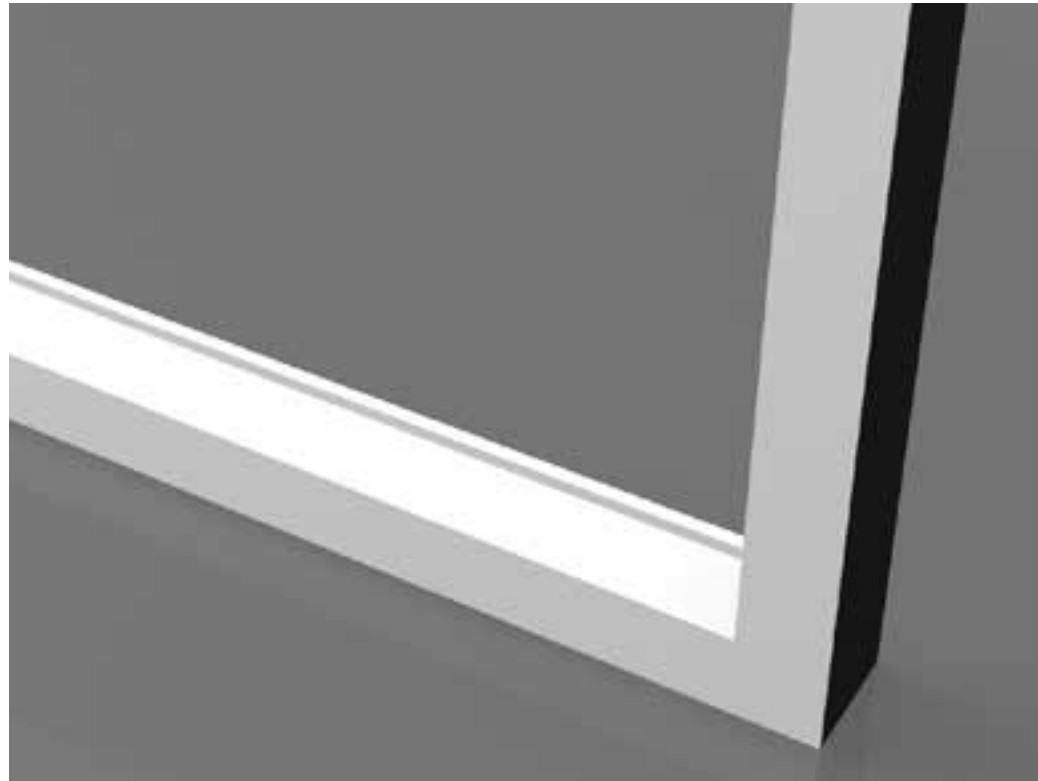

Toki

Assembling the wall is extremely simple. The first step is to place the base of the wooden frame on the floor and a side profile against a wall. Afterwards, the modules can be arranged like bricks in a wall, by placing them one next to the other in a row. To make the whole partition wall more stable, insert the iron crosses between the modules and proceed to stack the next row of modules on top of the first one. Your Toki wall can be put together dry or by filling the grout lines with putty. In case you are using modules with LED lights, make sure that all cables exits face the same side of the wall. The entire wall is eventually framed and protected by the solid wood profiles on top and on the side.

Toki Colours and surfaces

CAO - Kaolino



GR - Grey



AR - Slate



CF - Coffee



LA - Milk



	Milk	Grey	Slate	Kaolino	Coffee
Natural Colour					
Shiny Colour					
Opaque Colour					

Examples of combinations - colour and surfaces



Natural Grey
Natural Slate
Natural Milk



Natural Milk
Shiny Milk
Opaque Milk



Natural Coffee
Shiny Coffee
Opaque Coffee

Toki

Designer

Toki is the result of the joint work by designers Laura Pelosio and Giuseppe Bucco, who have invented this new form combining their creativity and a deep knowledge of the ceramic craft technique. The artists have set their sights on producing something, which could combine ceramic craftwork and architectural planning. Toki's research shifts between dynamic shapes and balanced harmony. Through an open dialogue on personal experience, imagination and creativity, Laura and Giuseppe have found in Lineasette the ideal laboratory where they could study and experiment new housing



LAURA PELOSIO

Conceives art as a necessary medium to improve the world and the environment we live in. During her educational journey, she has learned the design and production processes of artistic artifacts with a specific interest in the meaning these objects convey and the relationship they establish with the viewer. In every single creation, Laura looks for the Balance of the composition in order to obtain the Beauty, which has always characterized our culture.



GIUSEPPE BUCCO

Art diploma at the Art Institute of Nove, Vicenza. It is easy to recognize his touch on the Lineasette collections. The sinuous lines and the ability of conveying emotions and shape dynamism are the emblematical traits of his work. With every creation, he aspires to communicate his passion for life, harmony and freedom beyond limits.

Toki



Articolo T5001

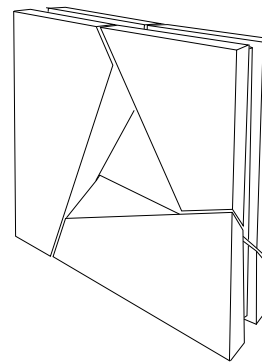

Simple Module
cm 33x33x8

Articolo T5002

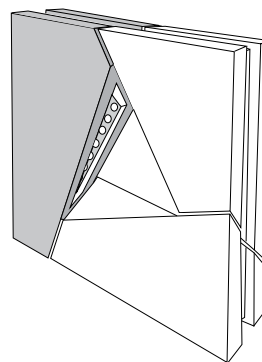

Light Source
Module
cm 33x33x8

Articolo T5003

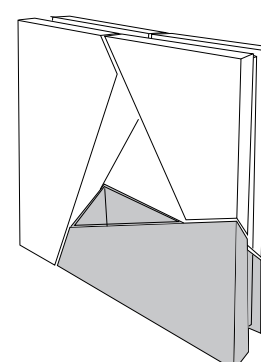

Vase Module
cm 33x33x8

Articolo T5004

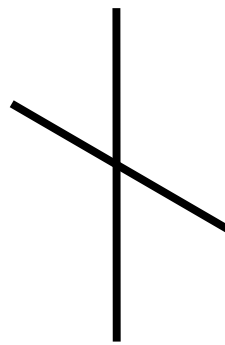

Iron Cross 6mm
cm 30x30x0,6

Articolo T5005

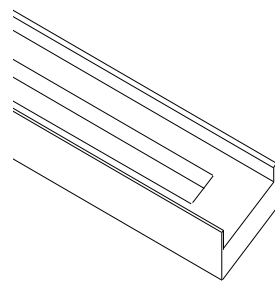

Wooden Frame
cm 300x10x6



Lineasette sas di Emanuele Bucco & C. Via Luca Della Robbia 2
36063 Marostica (VI) ITALY tel +39 0424 75487 - Fax +39 0424 470369
www.lineasette.com e-mail: info@lineasette.com